

PREPARED BY:
SALT LAKE CITY ENG.
349 SOUTH 200 EAST SUITE 100
SALT LAKE CITY, UTAH 84111

PREPARED CONSULTANTS:
N/A

PROFESSIONAL SEAL:
LANDSCAPE ARCHITECT
RONALD B. SALISBURY
103582-5301
State of Utah

PROJECT IDENTIFICATION:
MEMORY GROVE SIDEWALK RENOVATION

PROJECT OWNER:

MARK	DATE	DESCRIPTION

PREPARED BY: **R. SALISBURY**
CONTRACT #: _____
PROJECT #: _____
FILE #: _____
DRAWING FILE: _____
DRAWN BY: **R. SALISBURY**
CHECKED BY: **K. SHIELDS**
COPYRIGHT: _____

SHEET TITLE:
DEMOLITION AND GRADING PLANS

SHEET IDENTIFIER:
LD100
BINDING ORDER: **1**



MARK	DATE	DESCRIPTION

PREPARER: **R. SALISBURY**
 CONTRACT #:
 PROJECT #:
 FILE #:
 DRAWING FILE:
 DRAWN BY: **R. SALISBURY**
 CHECKED BY: **K. SHIELDS**
 COPYRIGHT:

SHEET TITLE:
**LAYOUT PLAN
 WALK DETAIL**

SHEET IDENTIFIER:
LS100
 BINDING
 ORDER **2**

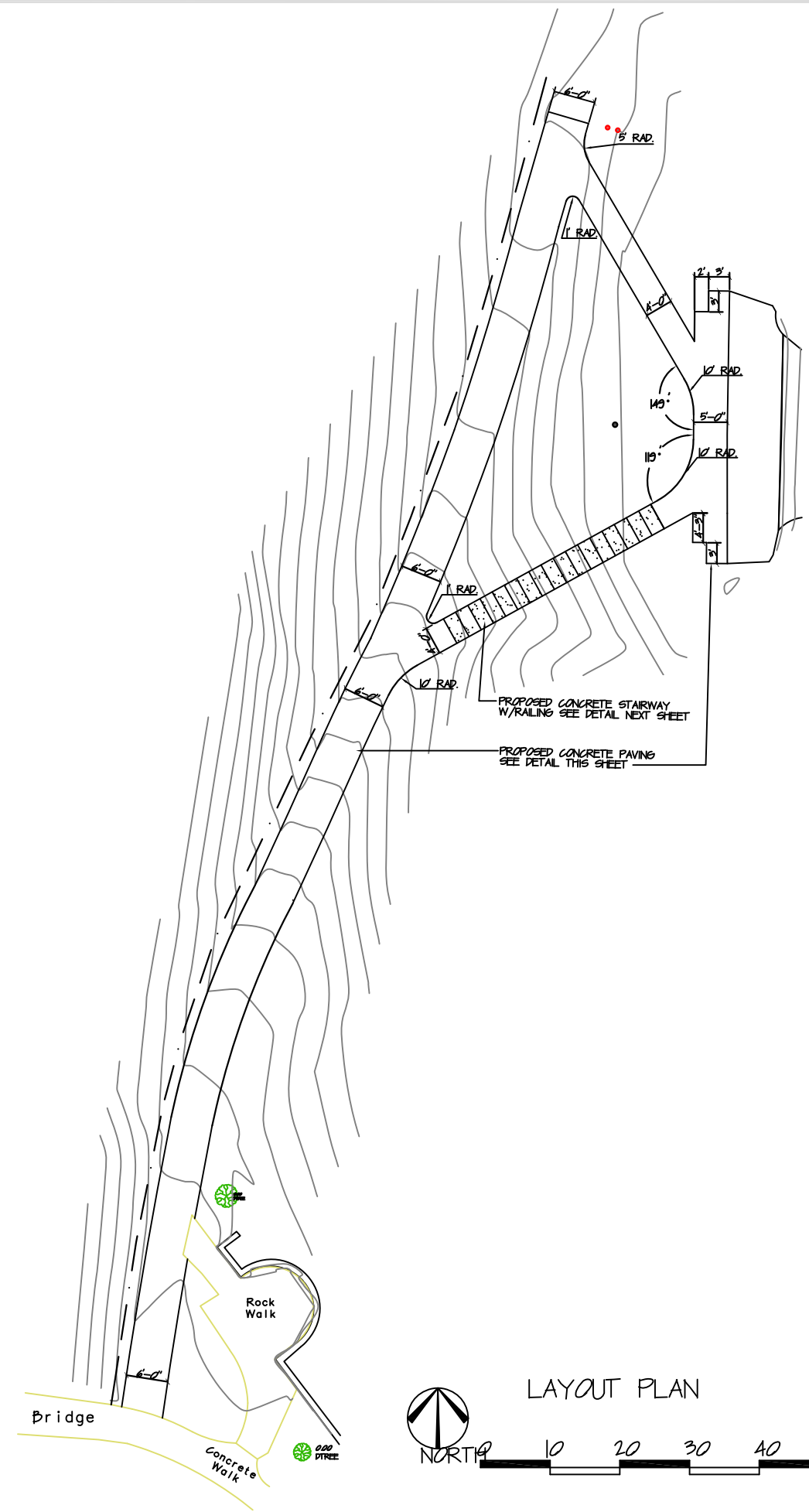

4" THICK 4000 PSI CONC. OVER 4" LAYER
 OF 1" MINUS GRAVEL PLACE 1" DEEP x 1/4"
 SCORE JTS. @ 6' O.C. AND 1/2" TYPE F4
 EXPANSION ADJACENT TO ADJUTING CONCRETE
 AND @ 50' O.C.

LAWN/SOD OR PLANTING BED
 DEPTH VARIES 1 1/2" FOR SOD 4" FOR
 PLANTING BED

COMPACT SUBGRADE TO 95% MAX. DRY DENSITY

CONCRETE PAVING DETAIL
 NTS

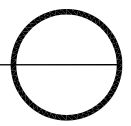
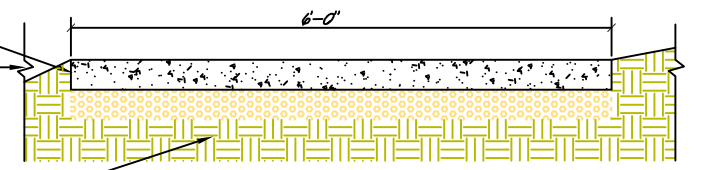

LAYOUT PLAN

